



**PARA**  
**SNOW SPORTS**



**RIFLE CHECK ASSIGNED TIMES: Sunday 11 Dec at 15:00->**  
**Location: lecture room Teeri (1) in the building next to restaurant**

15:00	CAN
15:15	JPN
15:25	GER
15:35	FRA
15:45	KOR
16:00	KAZ
16:10	UKR

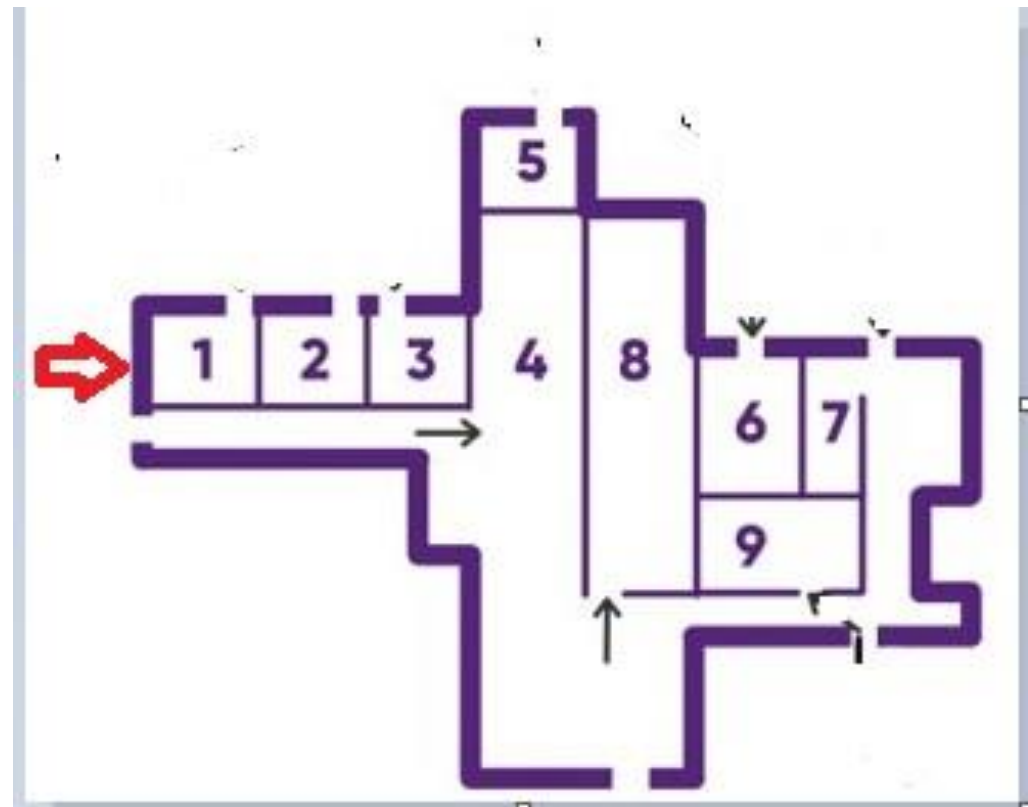

**BRING:** athlete rifles...spare rifles...air cannisters and spares...tools (if rifles need adjustment)...*patience! (We will check each rifle as quickly as possible.)*

**LOCATION:** We will meet in one of the conference rooms called TEERI on the hallway on the other side of the restaurant. Look for signs to direct you.

**IMPORTANT:** *The OC asks that you NOT carry your rifles through the restaurant. Instead, transport your rifles by exiting the building BEFORE you enter the reception area. Go past the front of the reception and restaurant entrance. There is a side entrance onto the hallway where the meeting room is located. Check map in previous slide.*

**FPDMS: We will be checking to see if each rifle (and spares) is in the athlete's database. A preliminary check (by the BtIR) shows that some athlete's rifles have incomplete information (for example, no rifle serial number entered). Please take a few minutes to check your athlete's rifle information and update the form, as needed and required.**

**NOTE: UNREGISTERED RIFLES CANNOT BE USED IN COMPETITION.**

**(Rule 12332.3.4)**

***KIITOS !!***